



Catalog Number	
Project	Type

FEATURES & SPECIFICATIONS

APPLICATION — The Embody with its high efficiency and smooth appearing light source is ideal for both retrofit and new construction, taking the place of the everyday look of a standard fluorescent troffer. The Embody is designed to fit into any standard drop ceiling that has no side obstructions prohibiting a clean fit. With 50,000 hours of life at L70 standard and a 5 year limited warranty the fixture maintenance cost is reduced substantially over time. The Embody is excellent for schools, municipalities, convenient stores, institutions, and all commercial applications.

CONSTRUCTION — The Embody Housing is constructed of structurally embossed, 22 gauge cold rolled steel. Shallow, light housing for easy installation. Post painted body with smooth sides for safe handling. Extra reinforcement in the body to create additional rigidity. Superior mechanical and gasketed light seal to eliminate any light from escaping; therefore, utilizing all the recycled light available. Integral T-Bar clips to secure fixture to T-Bar system.

FINISH — Post painted housing and components with a Lighting White Polyester type paint which has a UV stabilizer included with a 93% reflectivity. Raw steel goes through our custom wash system with a mild solvent and pre-treatment "rust inhibitor" before passing through a preheat oven. After the paint is applied the fixture then passes through the cure oven for maximum adhesion. Each fixture is painted to a minimum of 2-3 mil thickness for extra durability.

OPTICAL SYSTEM — Techlight's state of the art Diffuser sets new benchmarks for performance in key metrics such as transmission efficiency for a given level of diffusion or hiding power, beating holographic, surface relief and bulk diffuser techniques. We enable high transmission and a pleasant uniform light at the same time.

ELECTRICAL SYSTEM — Long life LED's and high efficiency drivers work together to provide superior performance in an efficient package to deliver optimal performance. LED's available in 4000K and 5000K with a CRI >82. Electronic drivers are available in 120/277 volt applications. 0-10V dimming as well as 50% step dimming capabilities comes standard. When in the step dimming 50% position the 0-10V leads may still be utilized for further dimming control.

LEMB24 SERIES

Embody LED 2x4 Recessed



SERIES	HOUSING HEIGHT	LENGTH & WIDTH
LEMB24	3.30"	47.75" x 23.75"

LISTINGS —ETL listed. LM79 and LM80 tested. This product is classified as Exempt based on the Photobiological safety evaluation report according to IEC/EN 62471.

WARRANTY — The complete luminaire is covered by a 5-year limited warranty.

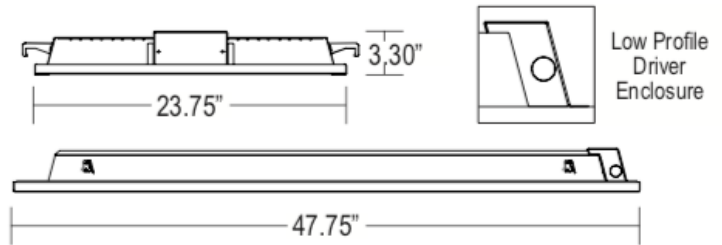

ORDERING INFORMATION

Choose the bold face options for the appropriate luminaire configuration for your application and enter on the line above each fixture attribute. Accessories may be factory installed, depending on the particular accessory chosen, but still be ordered as a separate line item.

EXAMPLE:

LEMB24406L1

LEMB24				
SERIES	COLOR TEMP/CCT	NOMINAL LUMENS	VOLTAGE	OPTIONS
	40 = 4000K 50 = 5000K	4L = 2,000 Lumens 6L = 3,000 Lumens 8L = 8,000 Lumens 10L = 10,000 Lumens 12L = 12,000 Lumens	1 = Multi-Volt ²	LEB13 = 1300 Lumen Emergency Ballast FBF = Fast-Blow Fuse SBF = Slow-Blow Fuse AC63 = 6' x 3X 18AWG, 3/8" dia., Armored Conduit Flex Cable AC64³ = 6' x 4X 18AWG, 3/8" dia., Armored Conduit Flex Cable CR⁴ = Clean Room (sealed fixture) HOEB = LED Battery Pack, 90 min, 5050 Lumens DLP = Dimming Leads Pulled DROC⁵ = On/Off Integral High Frequency Doppler Sensor

NOTES

¹ = Actual wattage may differ by ±5% while operating 120/277V ±10%.

² = Multi-Volt is 120/277V.

³ = Must be used with HOEB if AC is required.

⁴ = Meets or exceeds the requirements of Fed Std. 209E. Suitable for use in IES Class 1,000, 10,000 and 100,000 clean room environment.

⁵ = When placing sensors, avoid facing corridors or exits to prevent detecting traffic from adjacent areas. Also, maintain a 3-foot distance from fluorescent lights to prevent permanent "on" interference.

LUMINAIRE CHARACTERISTICS

Nominal Lumens	Wattage ¹	Delivered Lumens		LPW	L70 @ 25° C	Amperage Draw	
		4000K	5000K			120V	277V
4L	37	5114	5114	138	>50K	0.31 A	0.14 A
6L	52	7159	7159	137	>50K	0.44 A	0.19 A
8L	60	8182	8182	136	>50K	0.50 A	0.22 A
10L	76	10104	10104	132	>50K	0.64 A	0.28 A
12L	91	12126	12126	133	>50K	0.76 A	0.33 A

WARNING: Maintenance performed including the replacement of LED bricks while power is still supplied to the luminaire may result in system failures and will void the warranty.

