



Catalog Number	
Project	Type

FEATURES & SPECIFICATIONS

APPLICATION — The high performance retrofit is designed for applications where long life, low maintenance, and consistent color rendering are required. Areas with limited accessibility due to fixture location or where heavy pedestrian traffic makes maintenance difficult are ideal applications.

CONSTRUCTION — The heavy duty retrofit is constructed of die cast aluminum. The optical assemblies are sealed in place using a silicone gasket for weather tight protection. ETL listed for wet locations (IP64). A perforated sheet metal cover plate is provided.

FINISH — A Super Durable Polyester powder coat finish is electrostatically applied in our state of the art paint facility. Standard colors available: Black, Bronze, US Green, White. Custom colors available upon request.

OPTICAL SYSTEM — Made with a state of the art UV stabilized acrylic high performance refractive optical assemblies that use high transmissivity materials to achieve precise photometric distributions. Available in Type III, Type V Medium and Type V Wide beam configuration.

ELECTRICAL SYSTEM — Available in a high output LED system in a 4100K Neutral White color temperature propagated with Philips Lumileds Luxeon® MX LED's. Available with 90-300V 50/60 Hz Class II power supply. LED's rated for over 50,000 hours at 25°C ambient temperature. 0-10V dimming standard. Built-in surge protection up to 10 kV. Built-in Active PFC Function >95%/Full load. LED Power Supply conforms to UL1310 Class 2 and UL8750 standards and is IP67 rated for wet locations.

MOUNTING — Quick and easy installation by way of two mounting bolts that attach to existing Bega 9801 reflector collar.

BRM

BEGA 9801 RETROFIT MODULE

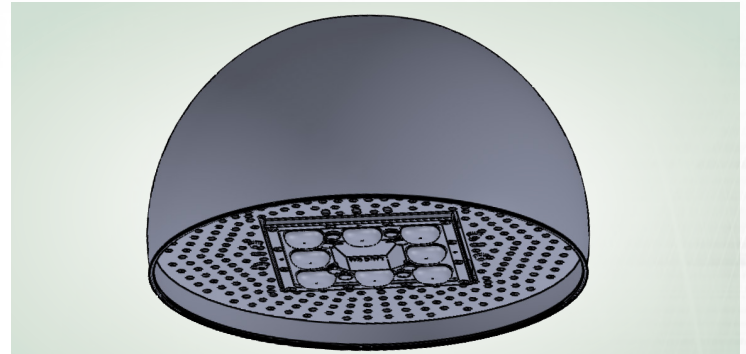

SERIES	MODULE HEIGHT	ADAPTOR PLATE DIAMETER
BRM	7.19"	Ø 13.75"

LISTINGS — LED Driver listed for wet locations (IP67). LED bricks ETL listed for wet locations (IP64). Meets US and Canadian safety standards. -40°C to 50°C ambient operation.

ORDERING INFORMATION

Choose the bold face options for the appropriate luminaire configuration for your application and enter on the line above each fixture attribute. Accessories may be factory installed, depending on the particular accessory chosen, but still be ordered as a separate line item.

EXAMPLE:

BRM 1 N M T3 D 1 BZ

BRM							
SERIES	# OF BRICKS	COLOR TEMP	# LED'S PER BRICK	OPTICS	DRIVE CURRENT	VOLTAGE	FINISH
	1 = 1 Brick	N = Neutral White (4100K)	M = 8 Luxeon MX LEDs	T3 = Type III T5M = Type V Medium T5W = Type V Wide	D = 1050 mA	1 = Multi-Volt ¹	BZ = Bronze BK = Black GR = US Green WH = White SP = Special ²

NOTES

- 1 = Multi-Volt is an auto ranging power supply from 100V to 300V input.
- 2 = Custom RAL color matching is available. Contact your sales representative for additional info.

FIXTURE DIMENSIONS

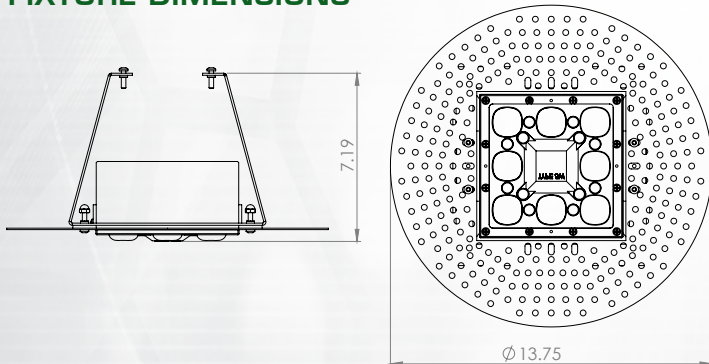

LUMINAIRE CHARACTERISTICS

# of LED Bricks	Drive Current	Color Temp	Delivered Lumens			System Wattage	L70 @ 25°C
			TYPE III	TYPE 5M	TYPE 5W		
1 BRICK	1050 mA	Neutral White (4100K)	11540	11825	11880	108	>50K

